



CODECO CORPORATION OF VERMONT

A Division of Codeco Corp.

Series: SM Surface Mount Wirewound Resistors

Codeco's SM series resistors are designed for use where the application is too severe for standard film resistors. These parts are molded into a rectangular shape to insure greater uniformity, easier handling, and minimum board space requirements. This design offers the advantage of superior resistance to voltage surges, improved temperature stability, negligible noise and higher power dissipation. All SM series parts are RoHS compliant.

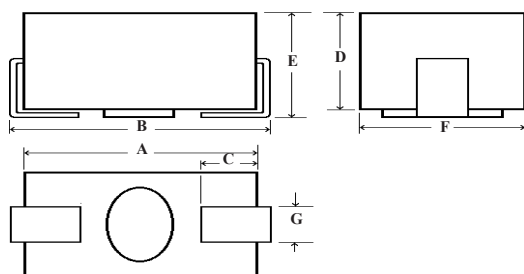

Type	Power Rating (watts)	Resistance Range (ohms)	Maximum Working Voltage	Dimensions						
				A ±.010	B ±.032	C ±.010	D ±.010	E ±.010	F ±.015	G ±.002
SMH	.5	.01 to 400	22.9	.200	.210	.040	.110	.096	.130	.060
SM1	1.0	.01 to 1K	28.2	.260	.280	.090	.140	.146	.150	.100
SM2	2.0	.01 to 2K	52.4	.410	.435	.100	.180	.240	.240	.115
SM3	3.0	.01 to 3.01	100	.629	.708	.110	.256	.276	.276	.115

Electrical Specifications:

- Power Ratings: .5 to 3 watts
- Resistance Range: 0.01Ω to 3.01K
- Tolerances: 1% to 5%
- Temperature Coefficients:
 - ±100PPM from 0.1Ω to 10Ω
 - ±20PPM from 10Ω to 3.01K
- Load Life: 1% DR maximum
- Short Term Overload: .5% DR maximum
- Temperature Cycling: .5%DR maximum
- Moisture Resistance: 1% DR maximum
- Terminations: Tinned copper

Features:

- All welded construction
- Flex terminals for thermal expansion
- Non-inductive windings available
- High temperature molded encapsulation

